

PARKING BRAKE

Cable

REMOVAL & INSTALLATION

Front Cable

1. Raise and safely support the vehicle.
2. Loosen the adjuster nut at the cable adjuster bracket.
3. Lower the vehicle.
4. Disconnect the front parking brake cable and conduit from the control assembly at the clevis using a $\frac{1}{2}$ in. (13mm) box-end wrench to press the conduit retaining prongs, then remove the cable-end pronged fitting from the parking brake control.
5. Remove the left-hand cowl side trim panel, then pull the carpet back to expose the cable and conduit.

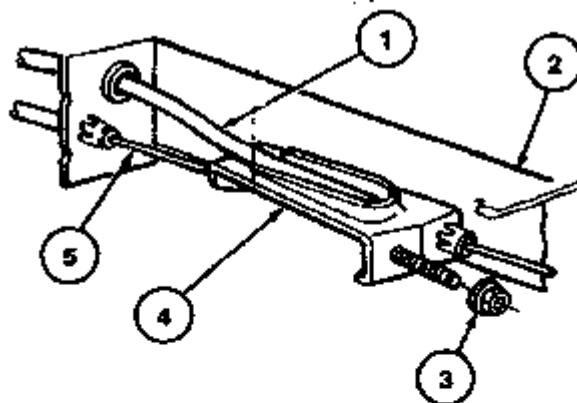

Item	Part Number	Description
1	2A635	LH Parking Brake Rear Cable and Conduit
2	10116	Inner Floor Side Member
3	W5202A2-S60	Adjuster Nut
4	2K390	Rear Parking Brake Cable Adjuster
5	2A635	RH Parking Brake Rear Cable and Conduit

Remove the left-hand cowl side trim panel, then pull the carpet back to expose the cable and conduit

[Click to enlarge](#)

6. Raise and safely support the vehicle.

7. Disconnect the front cable from the rear cable at the cable connector.
8. Remove the cable and push-in prong retainer from the cable bracket, using a 1/2 in. (13mm) box-end wrench to depress the retaining prongs.

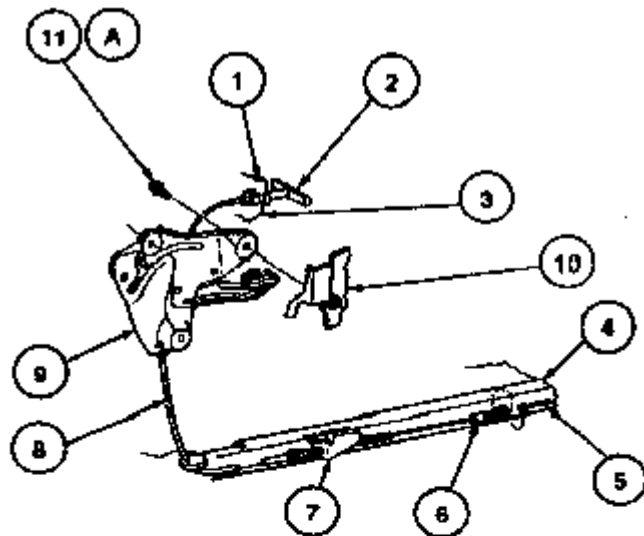

**AUTOMATIC AND MANUAL PARKING
BRAKE RELEASE HANDLE**

Item	Part Number	Description
1	391115-S411	Clip
2	2780	Parking Brake Release Handle
3	04320	Instrument Panel
4	11135	Front Floor Pan
5	2A635	Parking Brake Rear Cable and Conduit
6	2A709	Cable Connector
7	2K390	Rear Parking Brake Cable Adjuster
8	2853	Front Parking Brake Cable and Conduit
9	2780	Parking Brake Control
10	02344	Cowl Side Trim Panel
11	N800377-S2	Bolt (3 Req'd)
A	—	Tighten to 23-35 N·m (17-26 Lb·Ft)

Front parking brake cable and related components

[Click to enlarge](#)

9. Pull the cable assembly down through the floorpan hole.



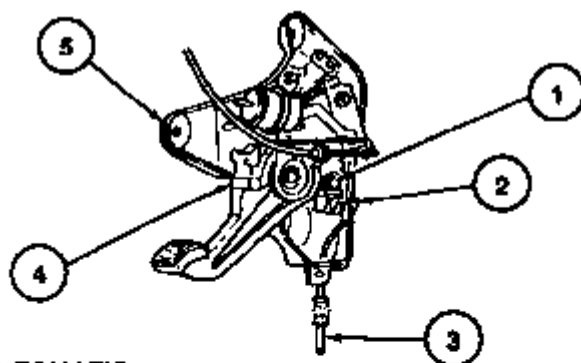

**AUTOMATIC
RELEASE**

Item	Part Number	Description
1	—	Clevis (Part of 2780)
2	—	Cable End (Part of 2853)
3	2853	Front Parking Brake Cable and Conduit
4	15A851	Parking Brake Signal Switch and Bracket
5	2780	Parking Brake Control

Pulling the front parking brake cable assembly down through the floorpan hole

[Click to enlarge](#)

To install:

10. Start the front parking brake cable and conduit through the hole in the floor pan, then secure the grommet in place.

The prongs must be securely locked into place.

11. Position the cable and conduit through the front cable bracket at the inner floor side member. Push the prong into the bracket. Seat the cable seal into the hole in the front floorpan.
12. Connect the rear cable to the front cable.
13. Carefully lower the vehicle.
14. Push the prong retainer into the parking brake control housing until the prongs are secure, then connect the front parking brake cable and conduit to the parking brake control clevis.
15. Reinstall the carpet and the left-hand cowl side trim panel.
16. Raise and safely support the vehicle.
17. Adjust the parking brake, following the procedure located in this section, then lower the vehicle and check the parking brake operation.

Rear Cable

LEFT SIDE

1. Raise and safely support the vehicle.

2. Remove the parking brake cable adjusting nut.
3. Remove the rear cable end fitting from the front cable connector.
4. If equipped with drum brakes, remove the wheel and tire, then remove the brake drum.
5. Disconnect the cable from the parking brake actuating lever. On vehicles equipped with drum brakes, use a $1\frac{1}{2}$ in. (13mm) box-end wrench to depress the conduit retaining prongs, then remove the cable end pronged fitting from the backing plate. On vehicles equipped with disc brakes, remove the E-clip from the conduit end of the fitting at the caliper, then remove the cable from the caliper.
6. Push the plastic snap-in grommet rearward to disconnect it from the inner floor side rail bracket.
7. Remove the pronged connector from the parking park adjuster bracket, then remove the cable assembly.

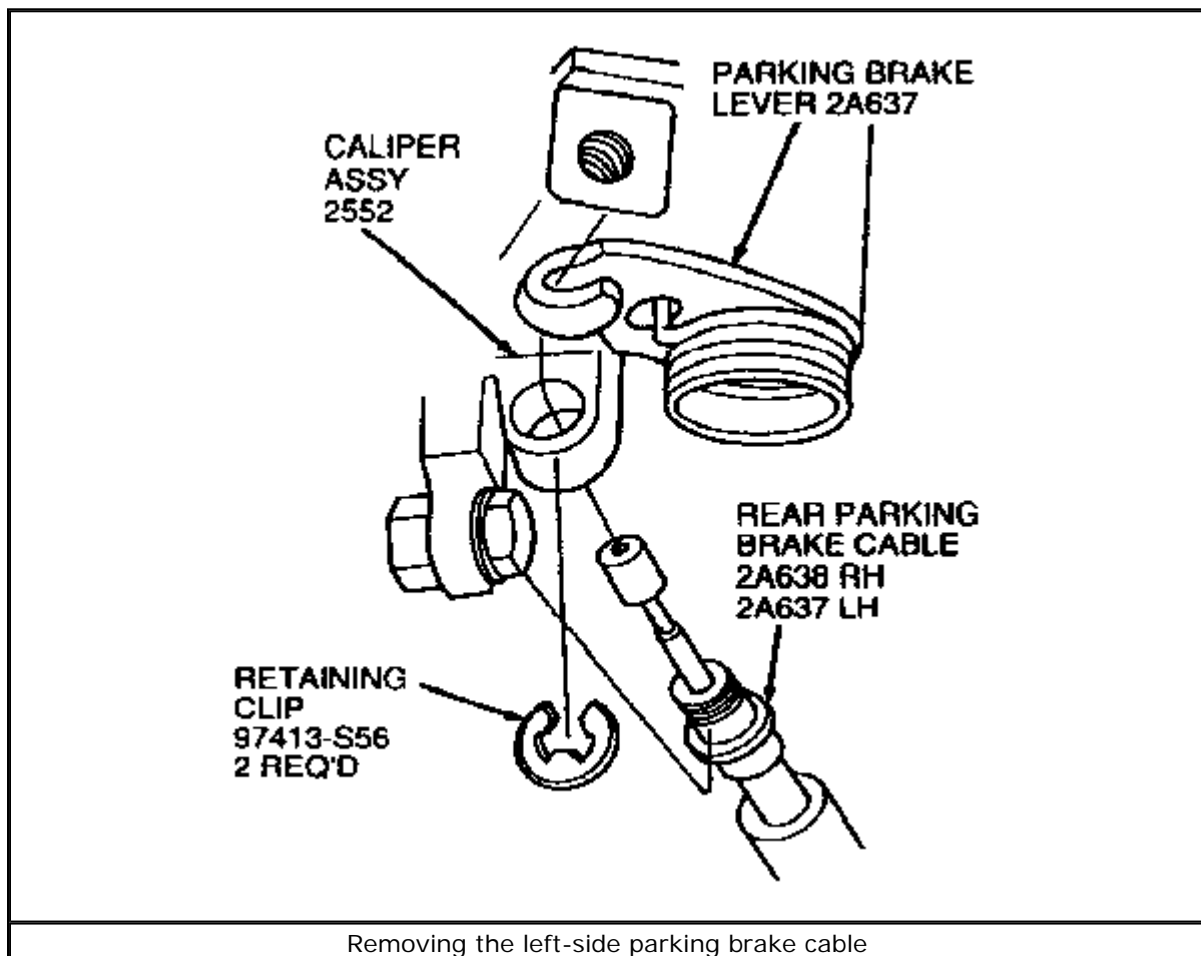

[Click to enlarge](#)

To install:

8. Insert the cable through the inner floor side rail bracket and cable adjuster. Make sure the pronged connector is securely attached to the adjuster.
9. Seat the plastic snap-in grommet inside the inner floor side rail bracket.

The left-side parking brake rear cable must be located over the right-side parking brake rear cable and conduit.

10. For vehicles equipped with drum brakes, insert the parking brake and conduit end into the support plate, then push the pronged cable end into the parking brake support plate hole. Make sure the prongs are locked into place.
11. Connect the brake cable to the parking brake actuating lever.
12. For vehicles equipped with disc brakes, insert the parking brake rear cable and conduit end into the caliper, then install the E-clip.
13. Attach the parking brake rear cable and conduit end to the parking brake lever.
14. Attach the parking brake rear cable and conduit to the parking brake front cable and conduit.
15. If equipped with drum brakes, install the drum, followed by the wheel and tire assembly.
16. Install the parking brake cable adjusting nut. Adjust the parking brake, as described later in this section.
17. Lower the vehicle, then check the parking brake for proper operation.

RIGHT SIDE

1. Raise and safely support the vehicle.
2. Remove the parking brake cable adjuster nut.
3. Use a $\frac{1}{2}$ in. (13mm) box wrench to remove the conduit retainer prongs, then remove the cable from the frame inner floor side rail bracket.
4. If equipped with drum brakes, remove the rear wheel and drum assembly.
5. Disconnect the brake cable from the parking brake actuating lever. On drum brake vehicles, use a $\frac{1}{2}$ in. (13mm) box end wrench to depress the conduit retaining prongs, then remove the cable end pronged fitting from the backing plate. On disc brake vehicles, remove the E-clip from the conduit end of the fitting at the caliper, then remove the cable and conduit from the caliper.
6. On Taurus/Sable sedans, perform the following:
 1. Remove the brake pressure control valve bracket at the control arm.
 2. Remove the cable retaining screw and clip from the lower control arm.
 3. Remove the screw from the cable bracket at the crossmember.
 4. Remove the entire right-side rear parking brake cable assembly.
7. On station wagons, perform the following:
 1. Remove the cable retaining clip and screw from each lower control arm.
 2. Remove the cable clip retaining screw from the lower control inner mounting bracket.
8. Remove the parking brake cable assembly from the vehicle.

To install:

9. Insert the cable and conduit into the opening in the inner floor side rail bracket and threaded end of the cable and conduit in the cable adjuster, then start the adjuster nut on the threads. Make sure the pronged fitting is pressed into the inner floor side rail bracket and securely locked into place.

10. Route the right-side parking brake rear cable and conduit under the left-side parking brake rear cable/conduit and rear control arm.
11. Secure the cable and conduit end into the parking brake lever.
12. For vehicles equipped with disc brakes, insert the parking brake cable and conduit end into the caliper, then install the E-clip.
13. For vehicles equipped with drum brakes, insert the cable and conduit end pronged fitting into the support plate, then lock securely into place.
14. Attach the brake hose clip, then install the nut and screw, then tighten to 6-8 ft. lbs. (8-11 Nm).
15. On station wagons, install the parking brake rear cable and conduit retaining clips to the rear suspension arm. On sedans, install the parking brake rear cable/conduit screw and clip, then tighten the screws to 6-8 ft. lbs. (8-11 Nm).
16. Position the cable and conduit assembly to the lower control arm, then tighten the retaining screw to 4-6 ft. lbs. (6-8 Nm).
17. On sedans, if applicable, fasten the brake load sensor proportioning valve to the control arm.
18. If equipped with drum brakes, install the rear wheel and drum assembly.
19. Install the parking brake cable adjuster nut.
20. Adjust the parking brake. following the procedure later in this section. Carefully lower the vehicle, then check the parking brake for proper operation.

ADJUSTMENT

Vehicles With Drum Brakes

1. Make sure the parking brake is fully released. Place the transaxle in the N position.
2. Raise and safely support the vehicle. Working in front of the left rear wheel, tighten the adjusting nut against the cable equalizer, causing a rear wheel brake drag. Then, loosen the adjusting nut until the rear brakes are fully released. There should be no brake drag. Refer to the accompanying figure for adjusting nut location.
3. If the brake cables were replaced, stroke the parking brake with about 100 lbs. (445 Nm) of pedal effort several times, then release the control and repeat Step 2.
4. Check for operation of the parking brake with the vehicle supported and the parking brake fully released. If there is any slack in the cables, or if the rear brakes drag when the wheels are turned, adjust as required.
5. Lower the vehicle.

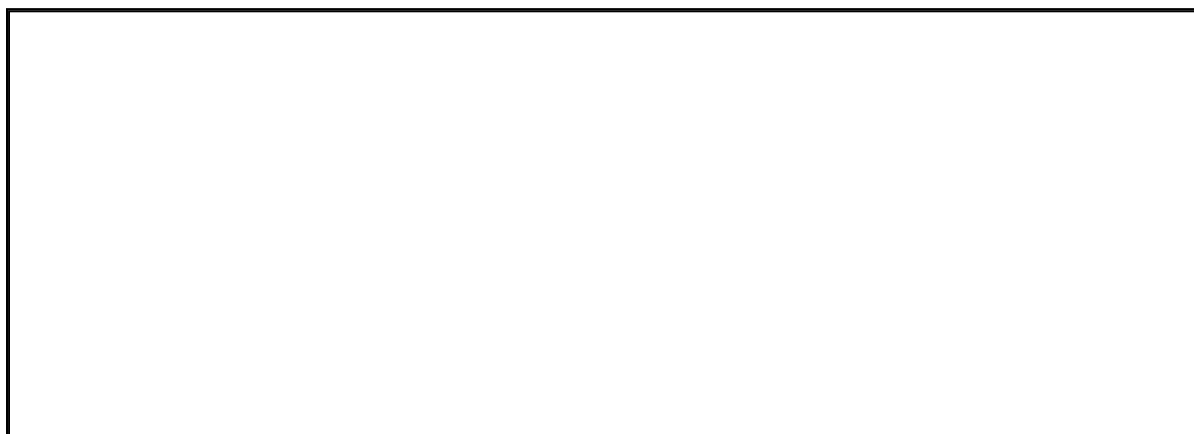

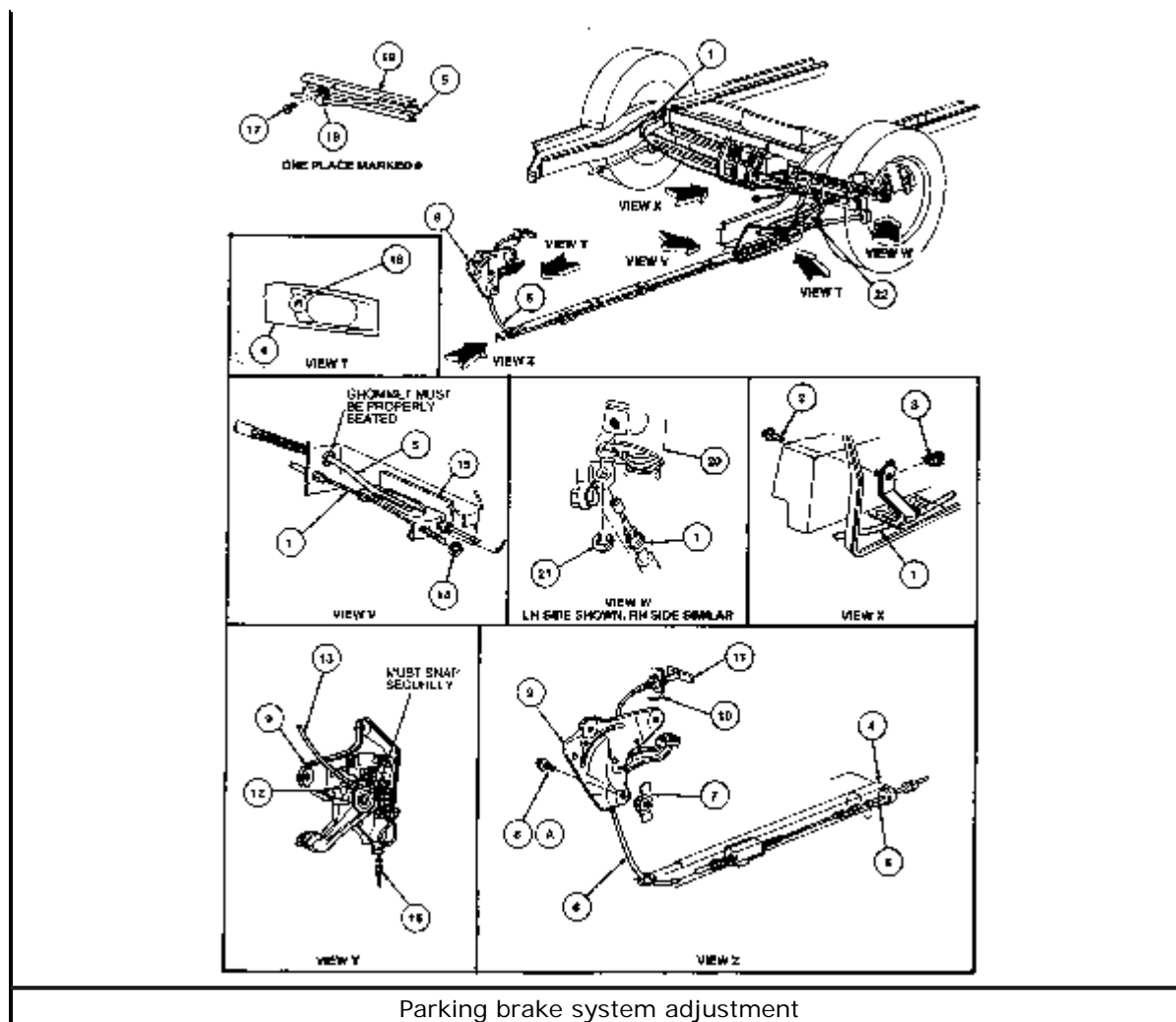

[Click to enlarge](#)

Vehicles With Disc Brakes

1. Make sure the parking brake is fully released.
2. Raise and safely support the vehicle.
3. Tighten the adjusting nut against the cable adjuster bracket until there is less than $\frac{1}{16}$ in. (1.6mm) movement of either rear parking brake lever at the caliper. Refer to the accompanying figure for adjusting nut location.
4. If the brake cables were replaced, stroke the parking brake with about 100 lbs. (445 Nm) of pedal effort several times, then release the control and repeat Step 3.
5. Lower the vehicle, then check operation of the parking brake.

Brake Pedal

REMOVAL & INSTALLATION

1. Fully release the parking brake. Raise and safely support the vehicle.
2. Remove all tension from the rear cables by backing off the adjusting nut from the equalizer or adjuster.
3. Lower the vehicle. If equipped, disconnect the vacuum hose from the parking brake release control motor.

4. Disconnect the release cable from the parking brake control release arm. Remove the release cable grommet from the parking brake control.
5. Disengage the wiring connector from the parking brake warning indicator switch. Remove the cable from the clevis at the brake control.
6. Remove the push pin from the cowl side trim panel.
7. Remove the conduit retainer from the control assembly by using a $1\frac{1}{2}$ in. (13mm) box-end wrench to press the retaining prongs.
8. Remove the three bolts and one push pin retaining the control assembly to the cowl side panel. Remove the control assembly from the vehicle.

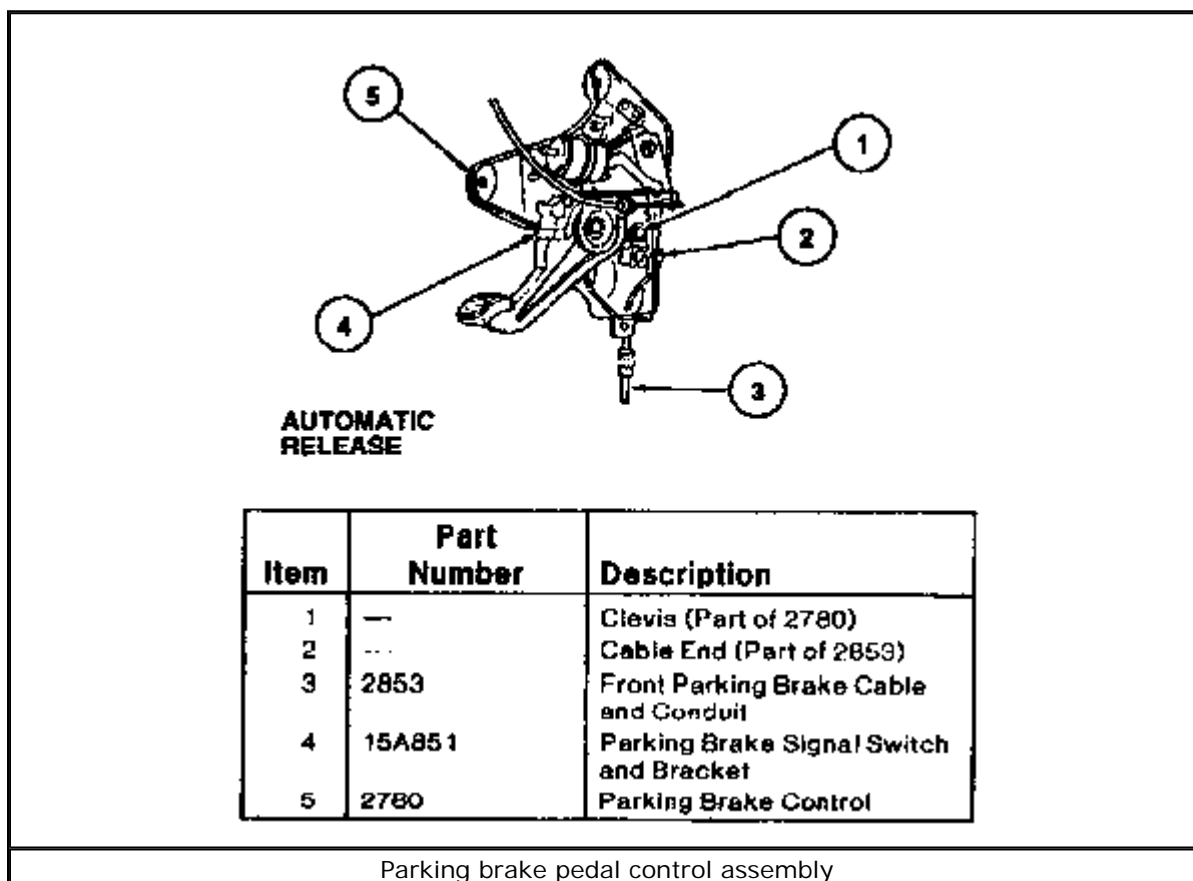

[Click to enlarge](#)

To install:

9. Position the control assembly in the vehicle. Fit the cable through its mounting hole, then press the pronged retainer in place. Make sure the prongs are locked securely into place.
10. Connect the cable to the control assembly. Install the retaining bolts and push pin. Tighten the retaining bolts to 17-26 ft. lbs. (23-35 Nm).
11. If equipped, connect the vacuum hose to the parking brake release control motor.
12. Connect the release cable to the parking brake control release arm. Install the release cable grommet to the parking brake control.
13. Engage the wiring connector to the warning switch and bracket.
14. Raise and safely support the vehicle. Adjust the parking brake assembly, as outlined earlier in this section.

- 15. Carefully lower the vehicle, then check the parking brake assembly for proper operation.**
-

Chilton® Automotive Information Systems. © 2004 Thomson Delmar Learning.