

# REAR DISC BRAKES

## Introduction

### CAUTION

Brake shoes may contain asbestos, which has been determined to be a cancer causing agent. Never clean the brake surfaces with compressed air! Avoid inhaling dust from any brake surface! When cleaning brake surfaces, use a commercially available brake cleaning solvent.

## Brake Pads

### REMOVAL & INSTALLATION

1. Remove the master cylinder cap and check the fluid level in the reservoir. Remove brake fluid as necessary until the reservoir is half full. Discard the removed fluid.

Item	Part Number	Description
1	MM00101-S-100	Bolt
2	2528 18 (LH) 25 190 (RH)	Rear Brake Anti-Lock Sensor
3	25 107 (LH) 25 100 (RH)	Rear Disc Brake Adapter
4	4800268-8100	Each (1 Req'd)
5	29229	Rear Wheel Disc Brake Shield
6	NE02126-82	Screw (1 Req'd)
7	4R477	Adjuster Nut (2 Req'd)
8	13125	Front Hub Cap Grease Seal
9	4B477	Rear Axle Wheel/Hub Flange
10	20026	Rear Disc Brake Flange
11	1123	Wheel hub
12	2328	Wheel Cylinder/Wheel Screw
13	2502, 2503	Rear Disc Brake Caliper
14	9907 148 818	Back (2 Req'd)
15	44013	Rear Wheel Spindle
A	-	Tighten to 4-6.82 Nm (40-50 Lb-in)
B	-	Tighten to 58-81 Nm (44-60 Lb-ft)
C	-	Tighten to 19 Nm (15 Lb-ft)
D	-	Tighten to 255-268 Nm (188-251 Lb-ft)
E	-	Tighten to 6-10 Nm (7-11 Lb-in)
F	-	Tighten to 87-112 Nm (64-80 Lb-ft)

Exploded view of the rear disc brake components-late model sedan with ABS shown

[Click to enlarge](#)

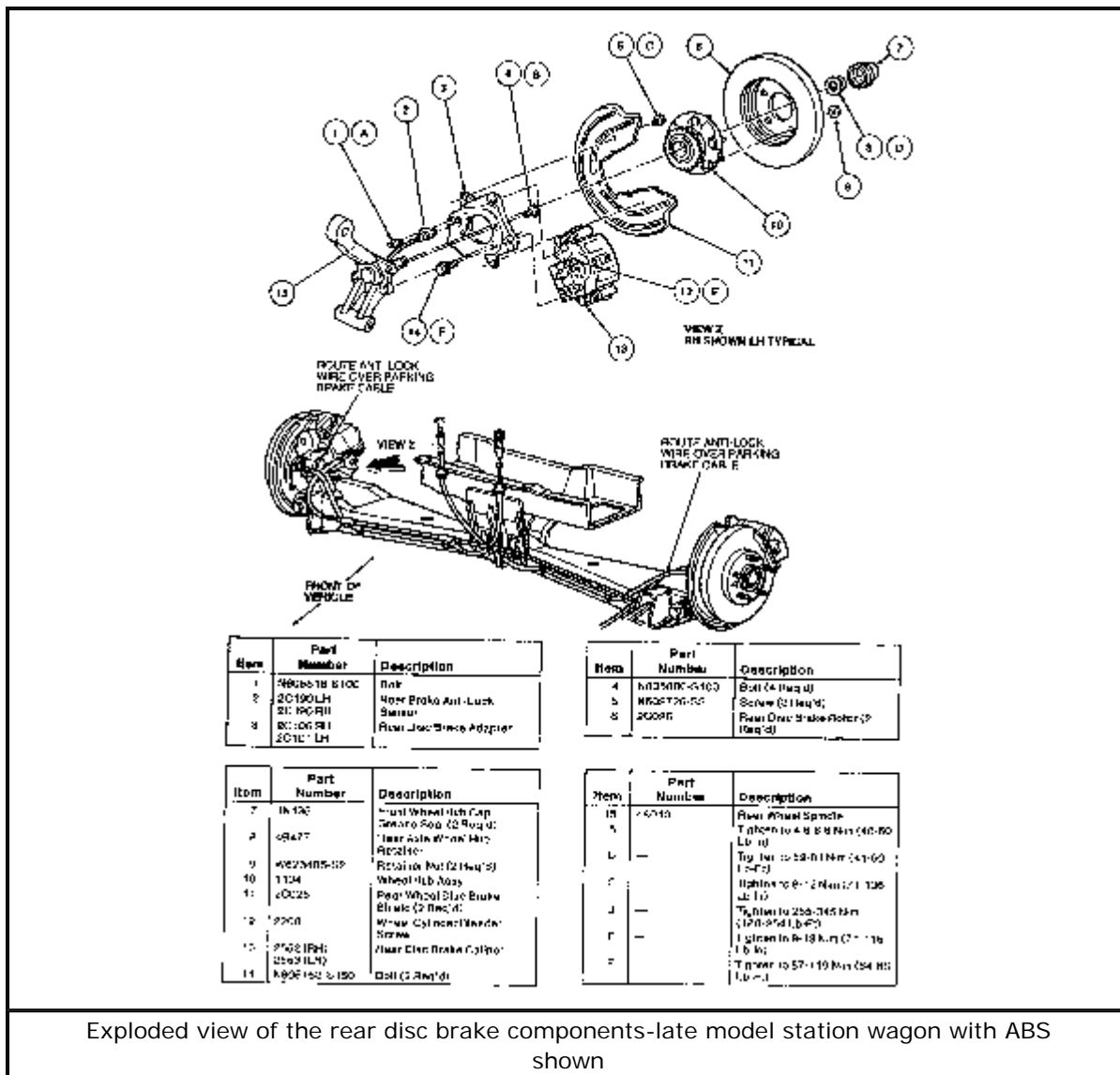

Exploded view of the rear disc brake components-late model station wagon with ABS shown

[Click to enlarge](#)

2. Raise and safely support the vehicle.
3. Remove the wheel and tire assembly.
4. Remove the screw retaining the brake hose bracket to the shock absorber bracket. Remove the retaining clip from the parking brake cable at the caliper. Remove the cable end from the parking brake lever.
5. Hold the slider pin hex-head with an open-end wrench. Remove the upper rear brake pin retainer/pinch bolt. Rotate the caliper away from the rotor.

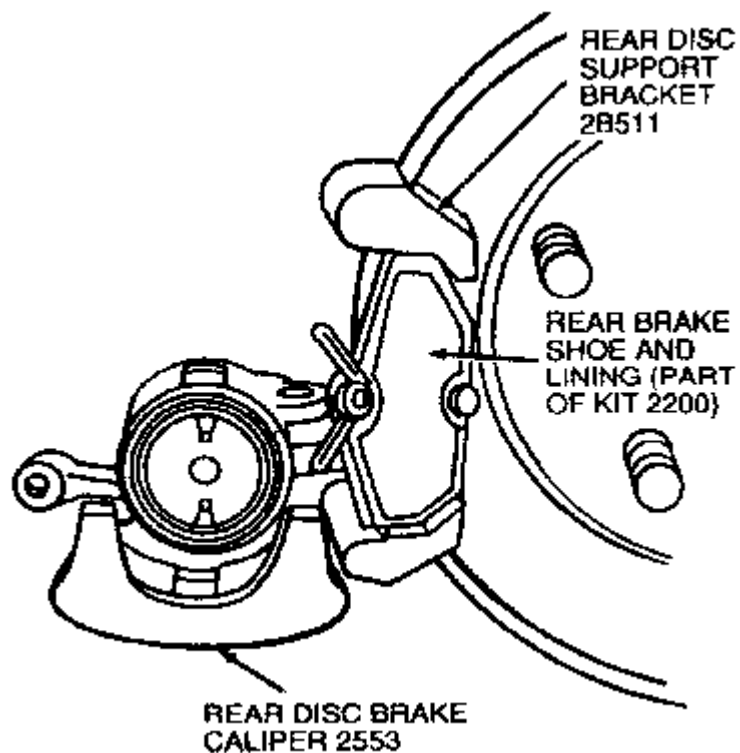

After removing the upper rear brake pin retainers or pinch bolt (as applicable) rotate the caliper away from the rotor

[Click to enlarge](#)

6. Remove the inner and outer brake pads from the rear disc support bracket/anchor plate.

To install:

7. Using Rear Caliper Piston Adjuster T87P-2588-A or equivalent, rotate the piston and adjuster clockwise until it is fully seated. Make sure one of the two slots in the piston face is positioned so it will engage the nib on the brake pad.

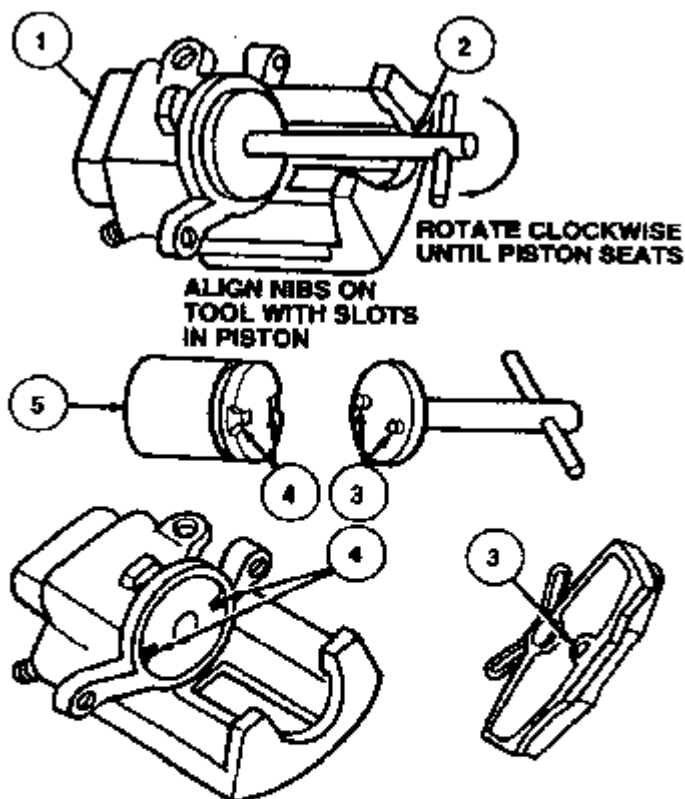

Item	Part Number	Description
1	2553	Rear Disc Brake Caliper Housing
2	T87P-2588-A	Rear Caliper Piston Adjuster
3	—	Nibs
4	—	Slots
5	2B588	Rear Disc Brake Piston and Adjuster

Make sure one of the two slots in the piston face is positioned so it will engage the nib on the brake pad

[Click to enlarge](#)

8. Install the inner and outer brake pads in the anchor plate/support bracket. Rotate the caliper assembly over the rotor into position on the anchor plate/support bracket. Make sure the brake pads are installed correctly.
9. Remove the residue from the rear brake pin retainers/pinch bolt threads, then apply one drop of Threadlock and Sealer E0AZ-19554-AA or equivalent to the threads. Install and tighten the retainers to 23-26 ft. lbs. (31-35 Nm) while holding the slider pins with an open-end wrench.
10. Attach the cable end to the parking brake lever. Install the cable retaining clip on the caliper assembly. Position the flexible brake hose and bracket assembly to the shock absorber bracket, then install the retaining screw. Tighten the screw to 8-11 ft. lbs. (11-16 Nm).
11. Install the wheel and tire assembly, then carefully lower the vehicle. Pump the brake pedal prior to moving the vehicle to position the brake linings. Refill the master cylinder.

## INSPECTION

The rear disc brakes can be inspected through an oval hole in the back of the brake caliper. Raise the rear of the vehicle, then remove the wheel and tire assembly to inspect the brake pads. If the brake lining thickness is less than 0.12 in. (3mm) the brake pads should be replaced.

## Brake Caliper

### REMOVAL & INSTALLATION

1. Raise and safely support the vehicle.
2. Remove the wheel and tire assembly.
3. Remove the brake hose from the caliper assembly.

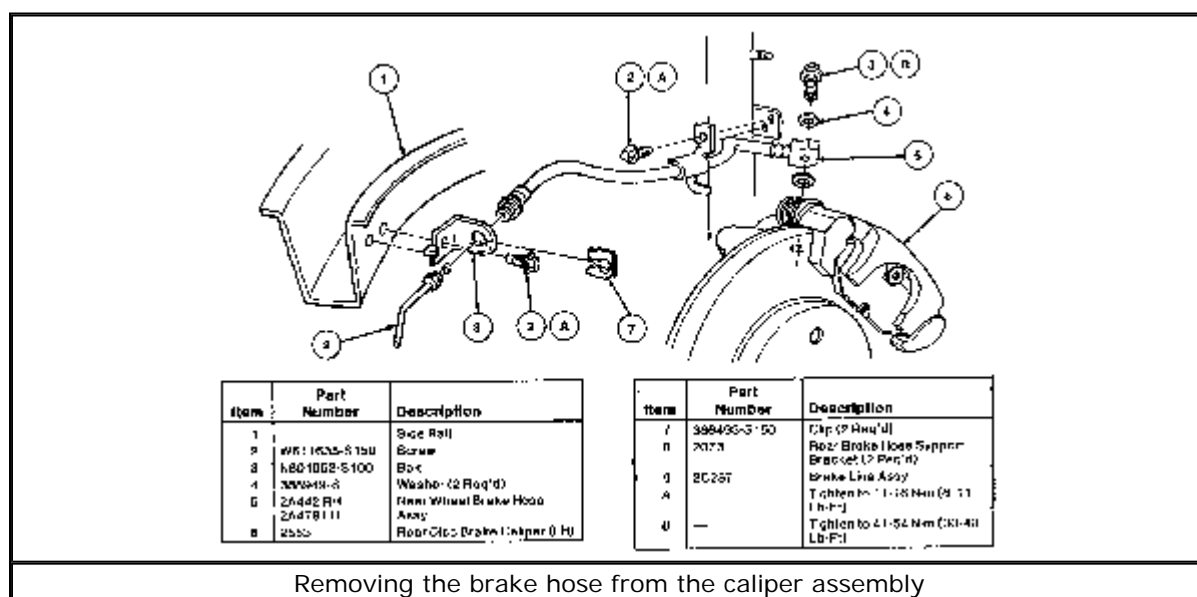

Removing the brake hose from the caliper assembly

[Click to enlarge](#)

4. Remove the retaining clip from the parking brake cable at the caliper. Disengage the parking brake cable end from the lever arm.



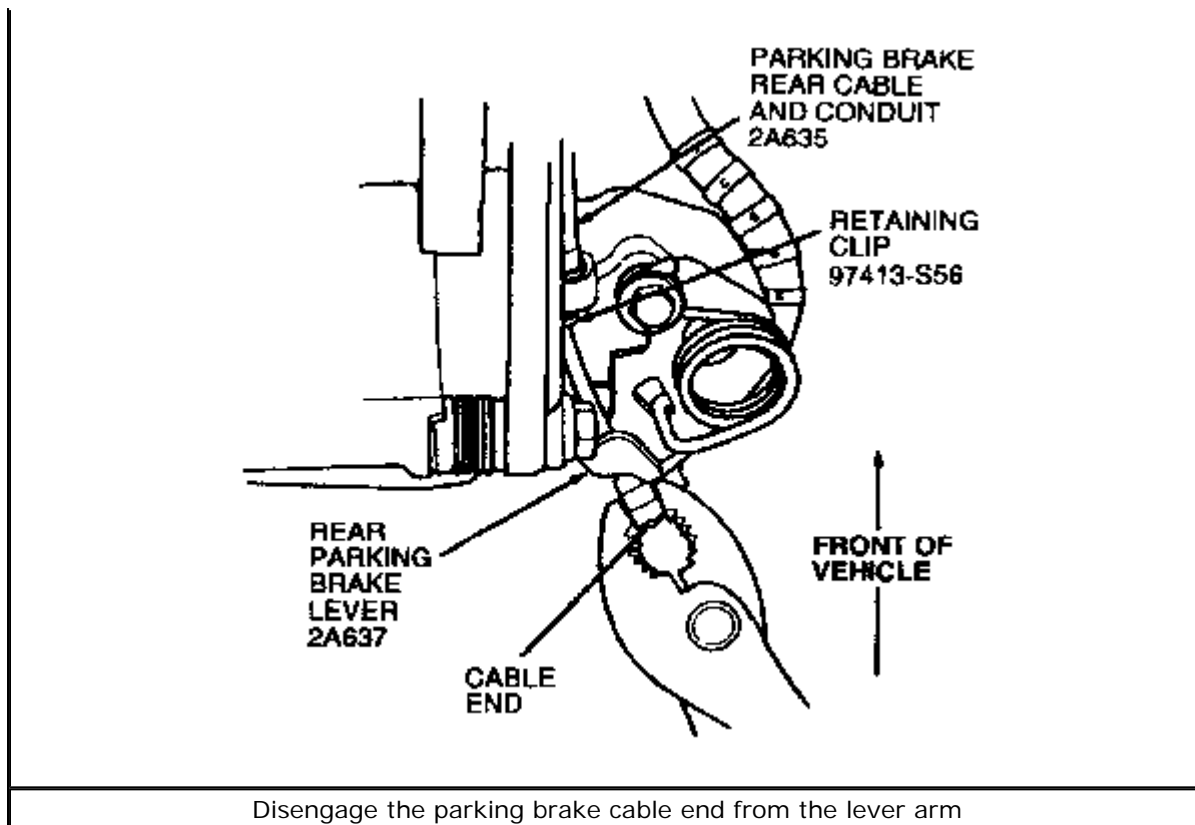

[Click to enlarge](#)

- Depending on vehicle application, hold one of the slider pin hex-heads with an open-end wrench, then remove the pinch bolt or pin retainer. Repeat for the other slider pin. Lift the caliper assembly away from the anchor plate. Remove the locating/slider pins and boots from the anchor plate/support bracket.

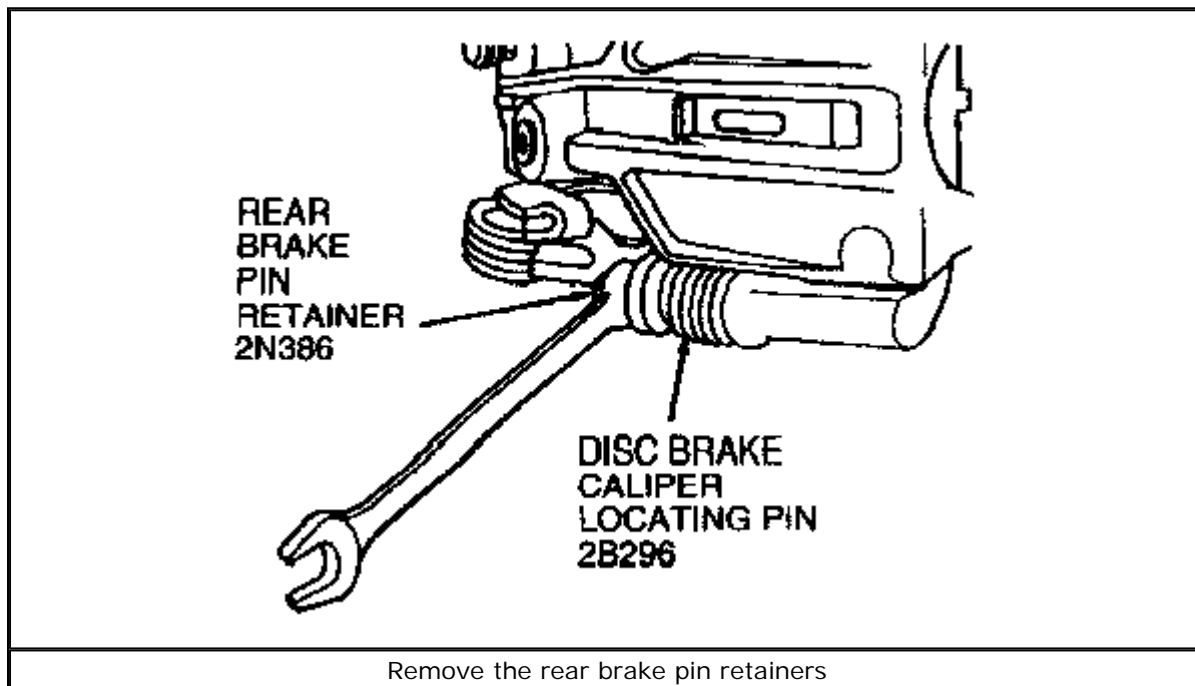

To install:

- Apply Silicone Dielectric Compound or equivalent to the inside of the locating/slider pin boots and to the pins.

7. Position the slider pins and boots in the anchor plate. Position the caliper assembly on the anchor plate. Make sure the brake pads are installed correctly.
8. Remove the residue from the pinch bolt threads, then apply one drop of Threadlock and Sealer E0AZ-19554-AA or equivalent. Install the pinch bolts or pin retainers, then tighten to 23-26 ft. lbs. (31-35 Nm) while holding the slider pins with an open-end wrench.
9. Attach the cable end to the parking brake lever. Install the cable retaining clip on the caliper assembly.

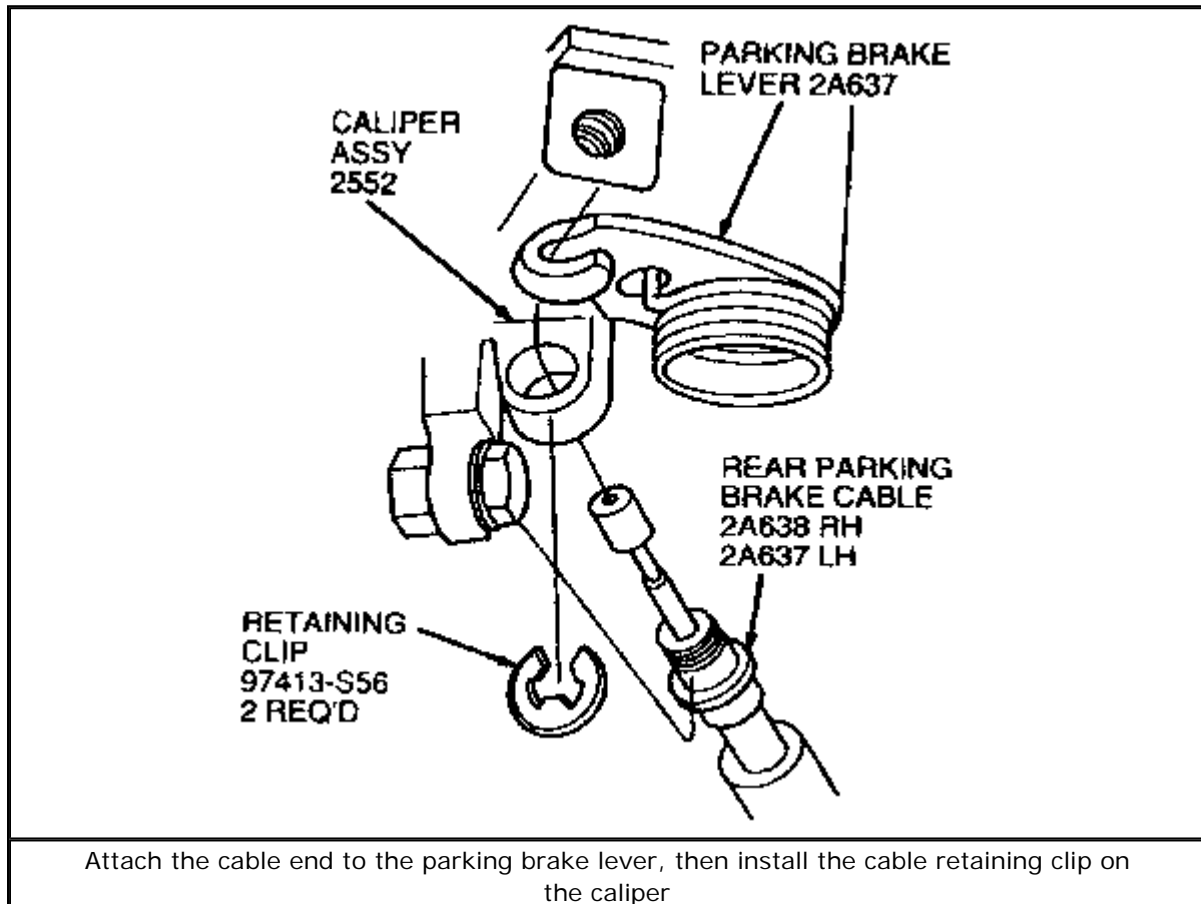

[Click to enlarge](#)

10. Using new washers, connect the brake flex hose to the caliper. For vehicles through 1992, tighten the retaining bolt to 8-11 ft. lbs. (11-16 Nm). For 1993-95 vehicles, tighten the retaining bolt to 30-40 ft. lbs. (41-54 Nm).
11. Bleed the brake system, filling the master cylinder as required.
12. Install the wheel and tire assembly, then lower the vehicle. Pump the brake pedal prior to moving the vehicle to position the brake pads.

## OVERHAUL

1. Remove the caliper assembly from the vehicle following the procedure earlier in this section.
2. Mount the caliper in a vise with soft-jawed protectors.
3. Using Rear Caliper Piston Adjuster T87P-2588-A or equivalent, turn the piston and adjuster counterclockwise to remove the piston from the bore.
4. Using snapping pliers, remove the snapping retaining the pushrod from the caliper.

**CAUTION**

The snapping and spring cover are under tension caused by spring load. Be careful when removing the snapping to avoid injury.

5. Remove the spring cover, spring, washer and key plate, then pull out the pushrod strut pin from the piston bore.
6. Remove the parking brake lever return spring, then unscrew the parking brake lever stop bolt and pull the parking brake lever out of the caliper housing.
7. Clean all metal parts with isopropyl alcohol. Use clean, dry compressed air to clean the grooves and passages. Inspect the caliper bores for damage or excessive wear. If the piston is pitted, scratched or scored replace the piston.

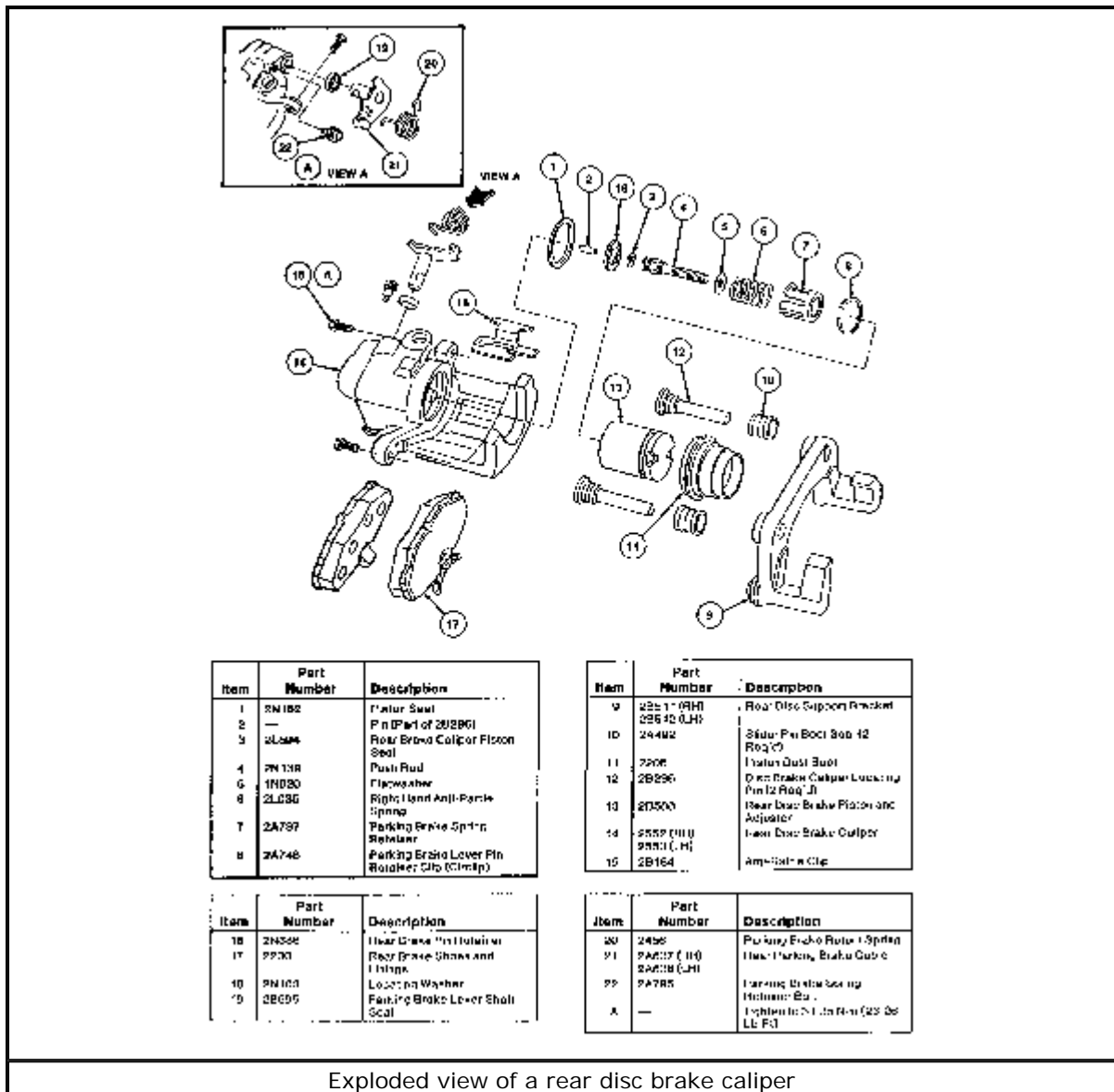

Exploded view of a rear disc brake caliper

[Click to enlarge](#)

To assemble:

8. Lightly grease the parking brake lever bore and the lever shaft seal with Silicone Dielectric Compound or equivalent. Press the parking brake lever shaft seal into



the caliper bore.

9. Grease the parking brake shaft recess and lightly grease the parking brake lever shaft. Install the shaft into the caliper housing.
10. Install the lever stop bolt into the caliper housing and tighten the bolt to 4.5-7.0 ft. lbs. (6-9 Nm).
11. Attach the parking brake lever return spring to the stop bolt, then install the free end into the parking brake lever slot.
12. Install a new O-ring seal in the groove of the pushrod. Grease the pushrod end with Silicone Dielectric Compound or equivalent.
13. Position the strut pin in the caliper housing and in the recess of the parking brake lever shaft. Install the pushrod into the bore. Make sure the pin is positioned correctly between the shaft recess. Install the flat washer, pushrod, spring and spring cover, in that order.

## Brake Rotor

### REMOVAL & INSTALLATION

1. Raise and safely support the vehicle.
2. Remove the wheel and tire assembly.
3. Remove the caliper assembly from the rotor, then support it with a length of wire. Do NOT let the caliper hang from the brake line.
4. For 1993-95 vehicles, unfasten the upper and lower support bracket-to-rear disc brake adapter bolts, then remove the rear disc support bracket.
5. Remove the two rotor retaining nuts, then remove the rotor from the hub.

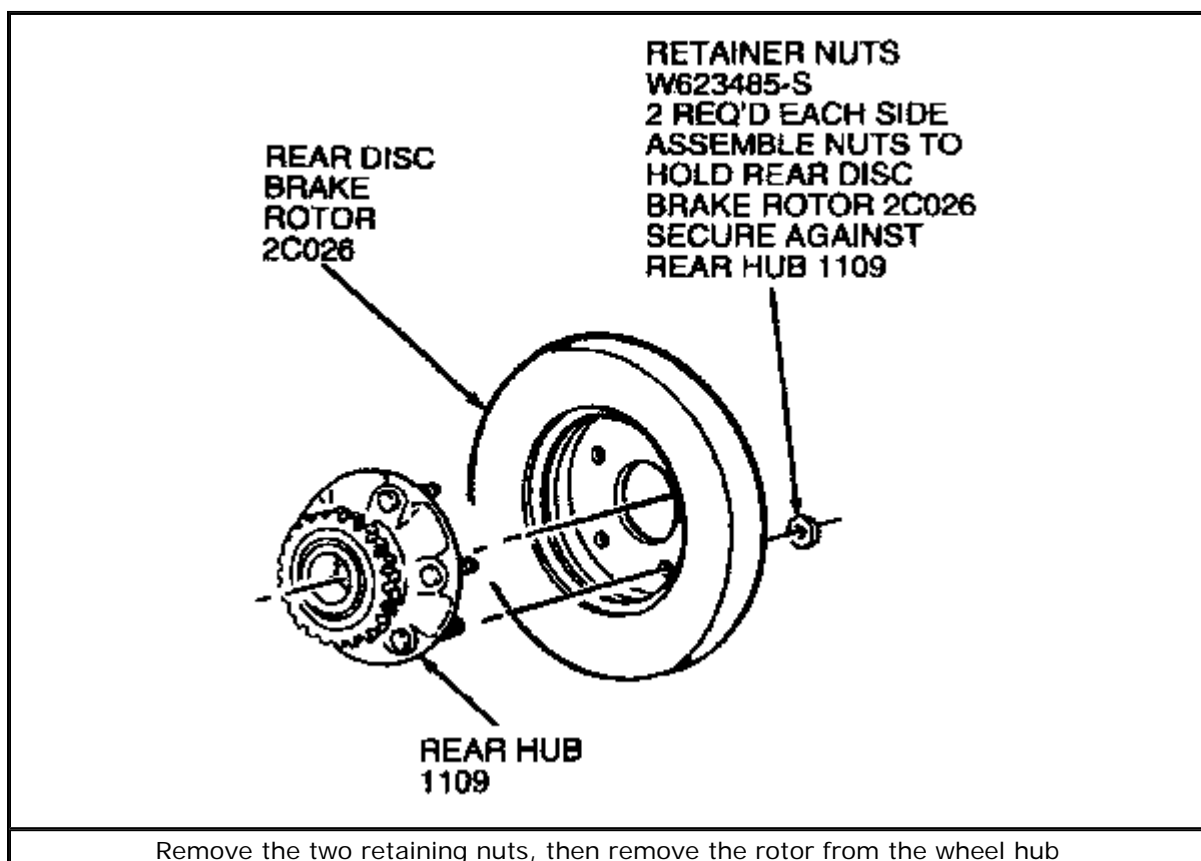

[Click to enlarge](#)

**To install:**

6. Check the rotor for scoring and/or other wear. Machine or replace, as necessary. If machining, observe the minimum thickness specification.
7. If the rotor is being replaced, remove the protective coating from the new rotor with Carburetor Tune-Up Cleaner D9AZ-19579-AA or equivalent.
8. Install the rotor on the hub, then fasten the two retaining nuts securely.

The support brackets are interchangeable from right or left.

9. For 1993-95 vehicles, install the support bracket. Position the bracket on the right or left-hand rear disc brake adapter, as applicable. Add one drop of Threadlock and Sealer E0AZ-19554-AA or equivalent to each bolt, then attach the bracket to the right or left-hand brake adapter. Tighten to 64-88 ft. lbs. (87-117 Nm).
10. Install the brake shoes and linings, then install the caliper assembly as outlined earlier in this section.
11. Install the wheel and tire assembly, then carefully lower the vehicle. Pump the brake pedal prior to moving the vehicle to position the brake pads.

## INSPECTION

Check the disc brake rotor for scoring, cracks or other damage. Rotor run-out should be measured while the rotor is installed, but rotor thickness or thickness variation may be checked with the rotor installed or removed. Use a dial gauge to check the rotor run-out. Check the rotor thickness to make sure it is greater than minimum thickness and check for thickness variations using a caliper micrometer. If the rotor is not within specification, either have it cut (if possible) or replace it.

---

Chilton® Automotive Information Systems. © 2004 Thomson Delmar Learning.