

FRONT OF ENGINE

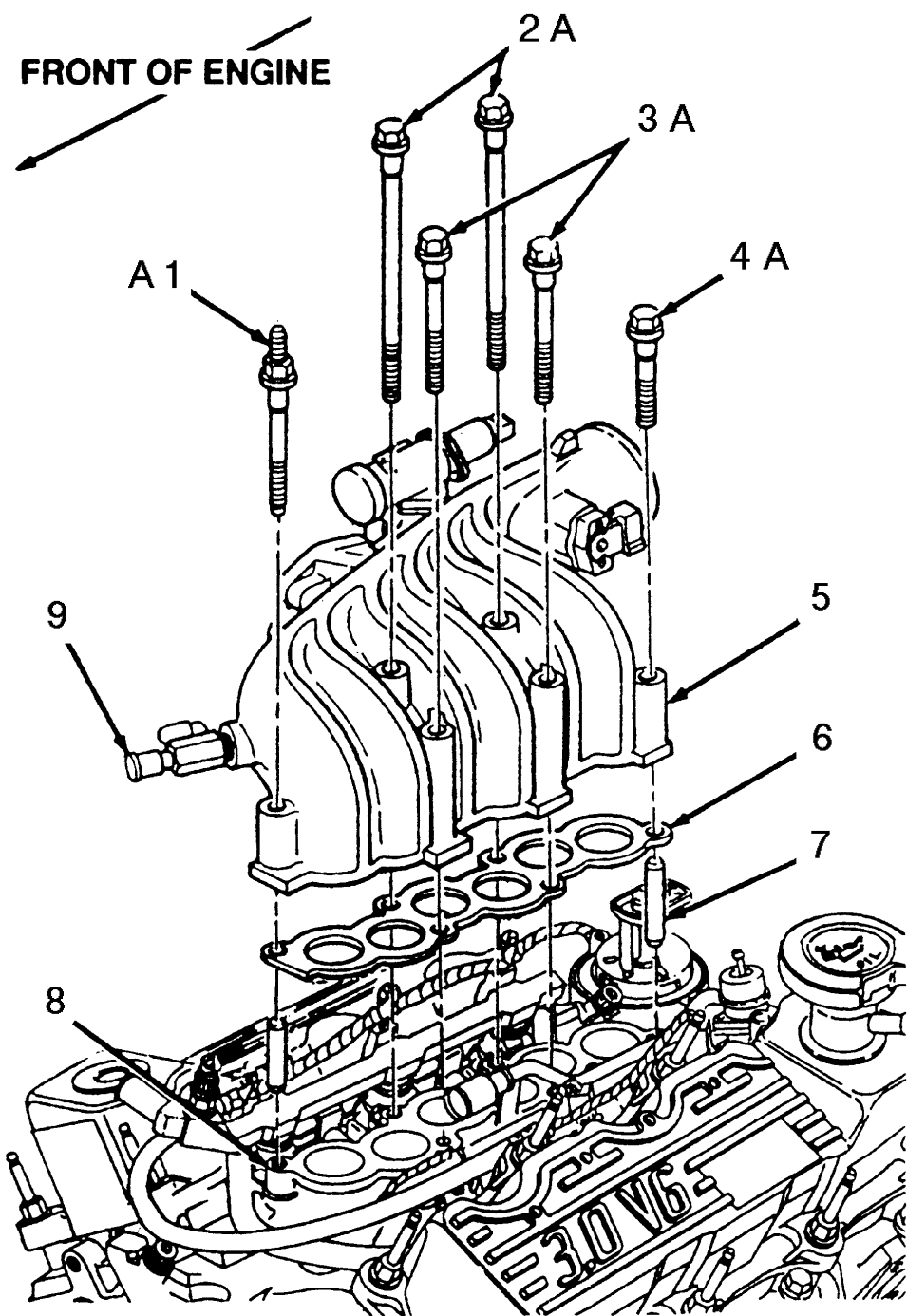

1A. Stud bolt

2A. Bolt-M8 x 1.25 x 130

3A. Bolt-M8 x 1.25 x 100

4A. Bolt-M8 x 1.25 x 68

5. Air intake throttle body

6. Air intake throttle body gasket

7. Guide pin

8. Lower intake manifold

9. Fitting and cap

A. Tighten to 20-30 N.m (15-22 lb-ft)