

# 3.8L SFI POLICE SEDAN

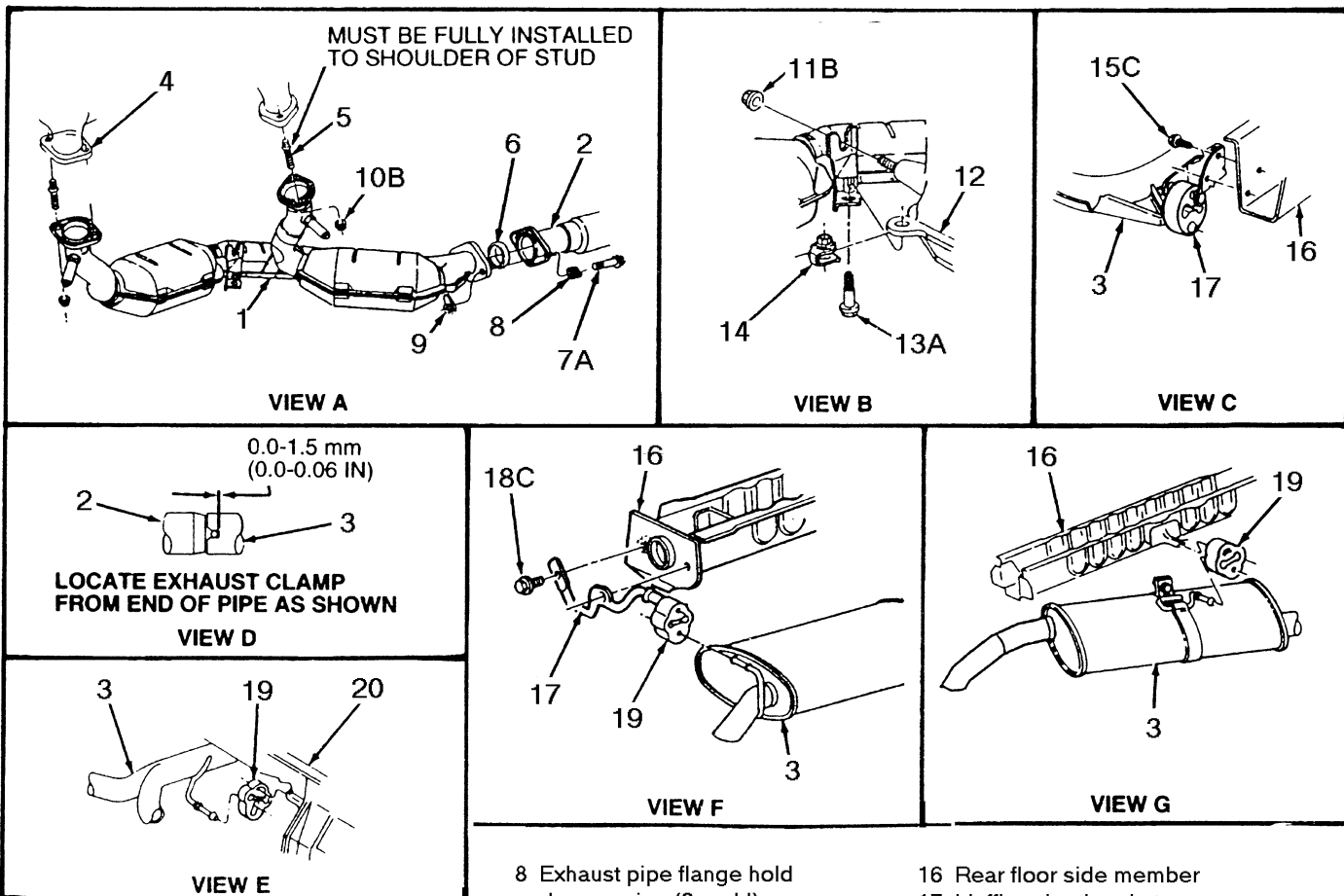
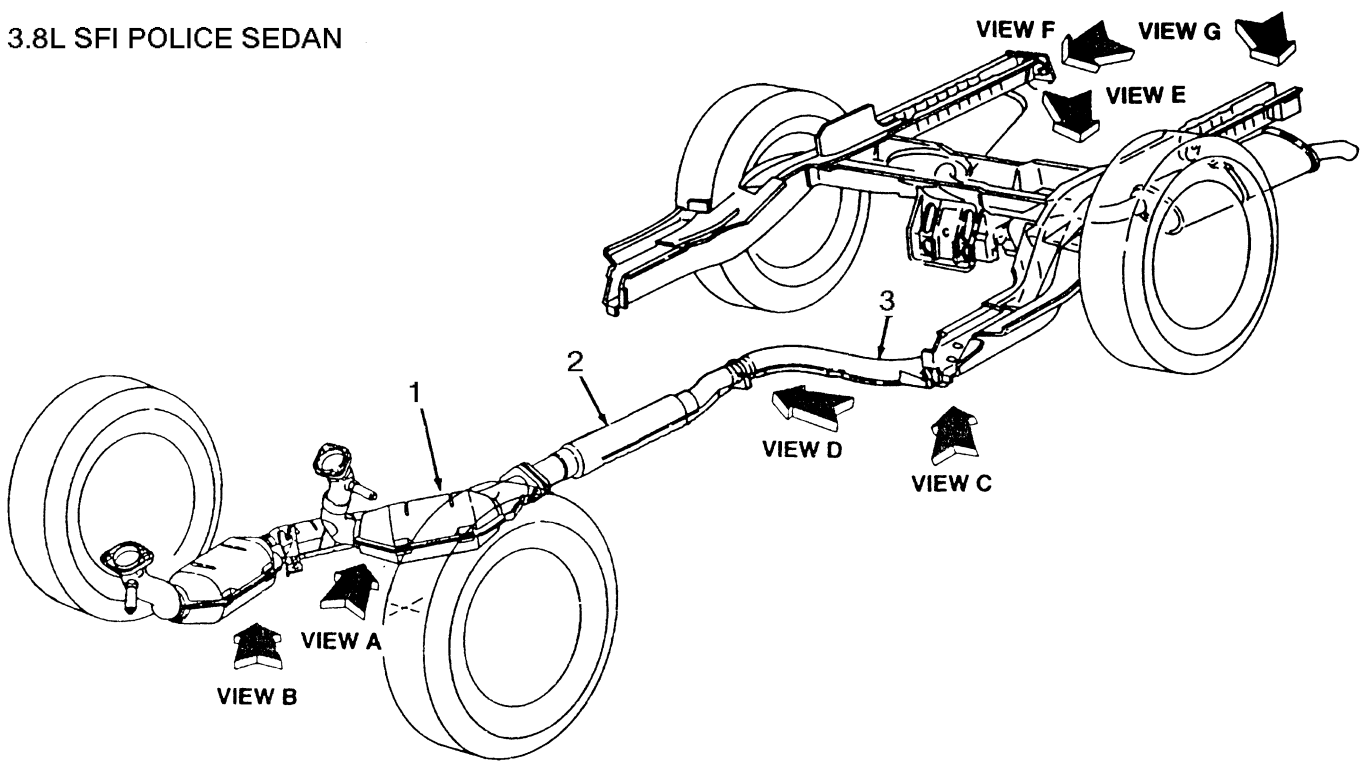

MUST BE FULLY INSTALLED TO SHOULDER OF STUD

VIEW A

VIEW B

VIEW C

0.0-1.5 mm  
(0.0-0.06 IN)

LOCATE EXHAUST CLAMP FROM END OF PIPE AS SHOWN

VIEW D

VIEW E

VIEW F

VIEW G

- 1 Dual converter Y pipe
- 2 Muffler inlet pipe and resonator
- 3 Muffler
- 4 Exhaust manifold (2 req'd)
- 5 Stud bolt (4 req'd)
- 6 Exhaust converter outlet gasket
- 7 Bolt (2 req'd)

- 8 Exhaust pipe flange hold down spring (2 req'd)
- 9 Nut (2 req'd)
- 10 Nut (4 req'd)
- 11 Nut
- 12 Transaxle case
- 13 Bolt
- 14 U-nut
- 15 Bolt (2 req'd)

- 16 Rear floor side member
  - 17 Muffler pipe bracket
  - 18 Bolt (2 req'd)
  - 19 Exhaust hanger Insulator (3 req'd)
  - 20 Rear floor cross member
- A Tighten to 29.7-40.3 Nm (22-30 lb.ft.)  
 B Tighten to 34-46 Nm (26-33 lb.ft.)  
 C Tighten to 14.8-20.2 Nm (11-15 lb.ft.)